

Mount the bigger counterweight as near as you can to the bearing block and tight the screw with the hex wrench. Pre assemble the smaller one

Pre assemble your cartridge on the tone arm. Please note, if you have, use the needle guard!!!

Adjust the stylus pressure of your cartridge via counterweights (approx.). Then tight the screw with the hex wrench. For this set up you need a cartridge balance. The exact data you find on your cartridge description

Now adjust approx. the VTA (turn the VTA screw counter wise), so that the cartridge is in level to the protractor.

Begin with the set up of your cartridge. Please note before you begin with the set up take off the needle guard if you have.

Please adjust the overhang and the angular offset according description of protractor

Check Armwand Movement

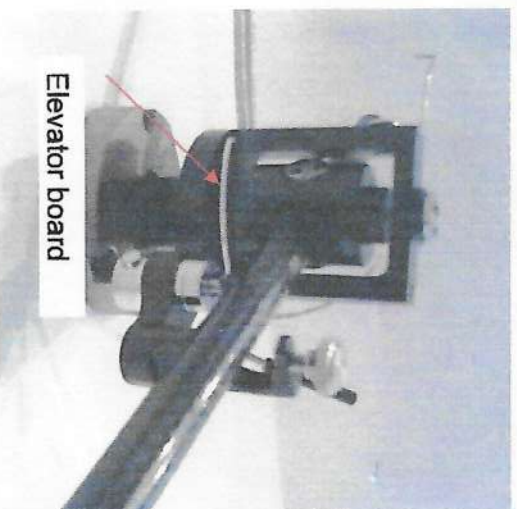

Elevator board



Make sure that the tone arm rests on the elevator board during from the beginning to the end of the L.P. This is important to not brok the needle.

DaVinci Audio Labs Protractor

DaVinci Protractor was designed for easy use. We chose an one-point-adjustment. As you can see on the picture below there are three radii printed on the disc that inscribe the tracking radii of the tonearms of 9, 10 and 12 inch geometry. The radii are marked by the alignment points with a) -> 9 inch, b) -> 10 inch and c) -> 12 inch.

Setup procedure:

1) Install tonearm using the supplied gauge at the correct pivot-spindle distance. The bore closest to the spindle is the correct mounting distance for the 9 inch tonearm, the next hole is for 10 inch and the bore with largest distance is for 12 inch tonearms resp.

2) Mount the cartridge and turn the tonearm over the disc. Choose the correct radius on the disc that fits your tonearm geometry and move the cartridge within the headshell so that the stylus tip touches the tracking curve. The stylus should inscribe the complete printed area of the tracking curve when moved towards or away from the spindle. If this is the case you have set up correct overhang.

3) In case you have a 9 inch tonearm you can align the cartridge at point a) to set up correct offset. The cantilever must be in parallel with the auxilliary lines. Once this is done you can check at points x0 and x0' for parallelity. If this is the case complete setup is finished in terms of planar geometry (no VTA!).

4) In case of 10 inch tonearms please refer to 3) using point b) and point c) corresponds to 12 inch design resp.

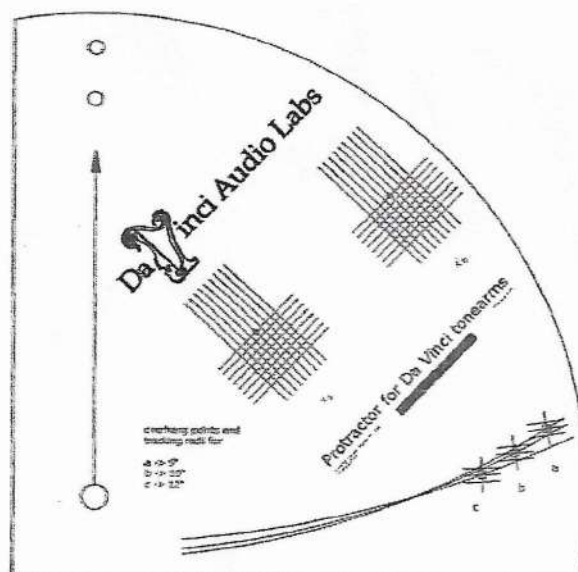

We wish you fun with your records!

Manual:
Tone arm „nobile“

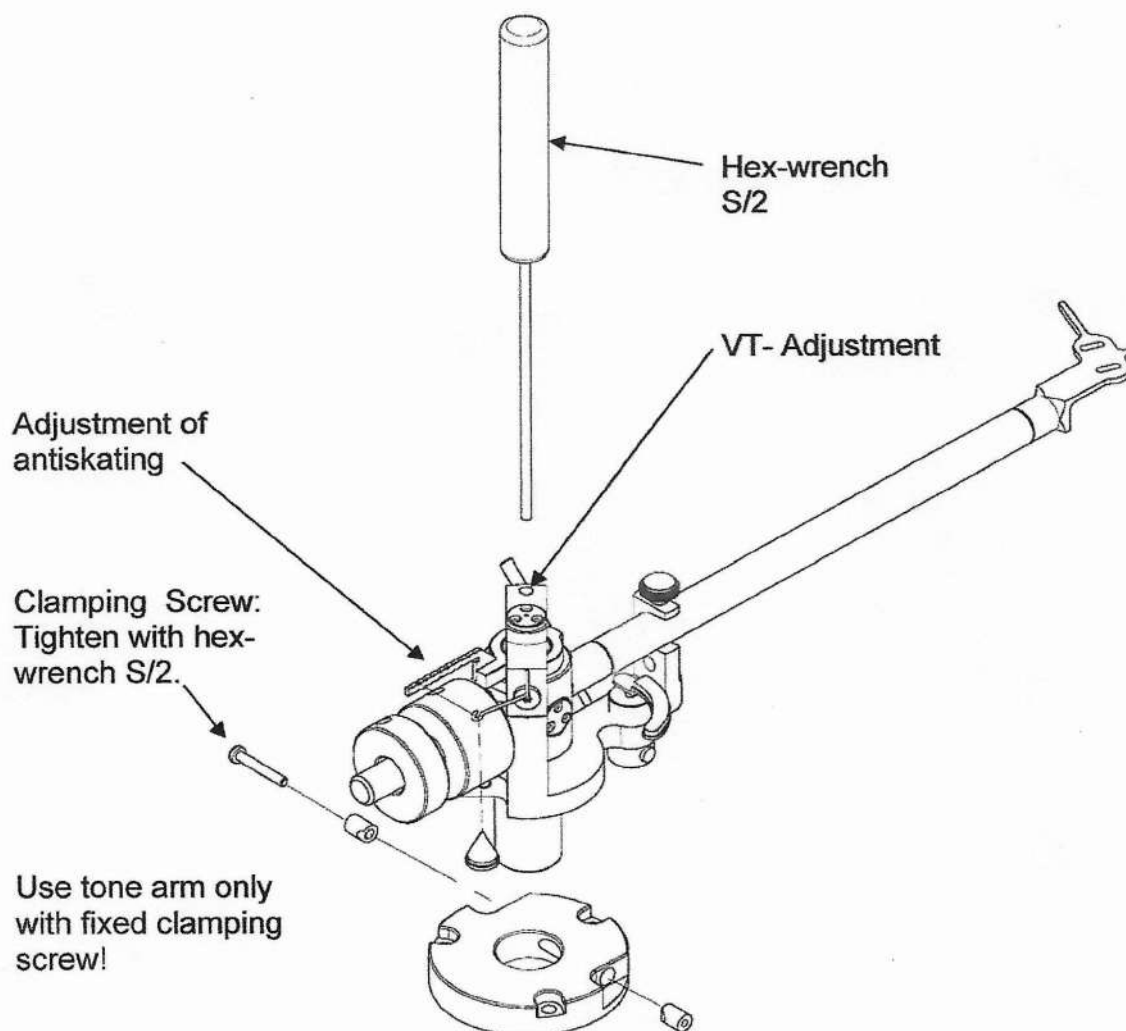

For geometrical adjustment please use included protractor and ruler from Dr. Feickert Analogue.

Distance – tonearm pivot to turntable center:

10" Unit	237.8mm
12" Unit	295.6mm

Adjust the definitive VTA, fix the Arm shaft clamp and turn the VTA a little bit counter wise, so that the screw don't touch's the arm collar. After this adjust the definitive weight of your cartridge according your cartridge description.

Anti-Skating

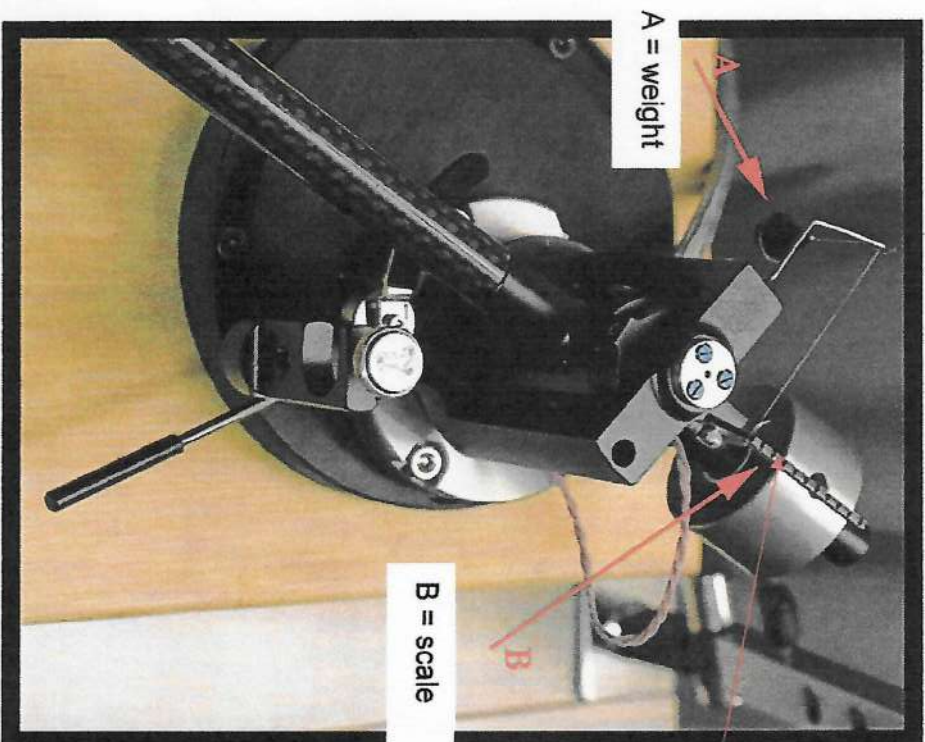

1. channel approx 1,00g Antiscating force = ASF
2. channel approx 1,25g ASF
3. channel approx 1,50g ASF etc. etc.

Check antiscating force with test LP

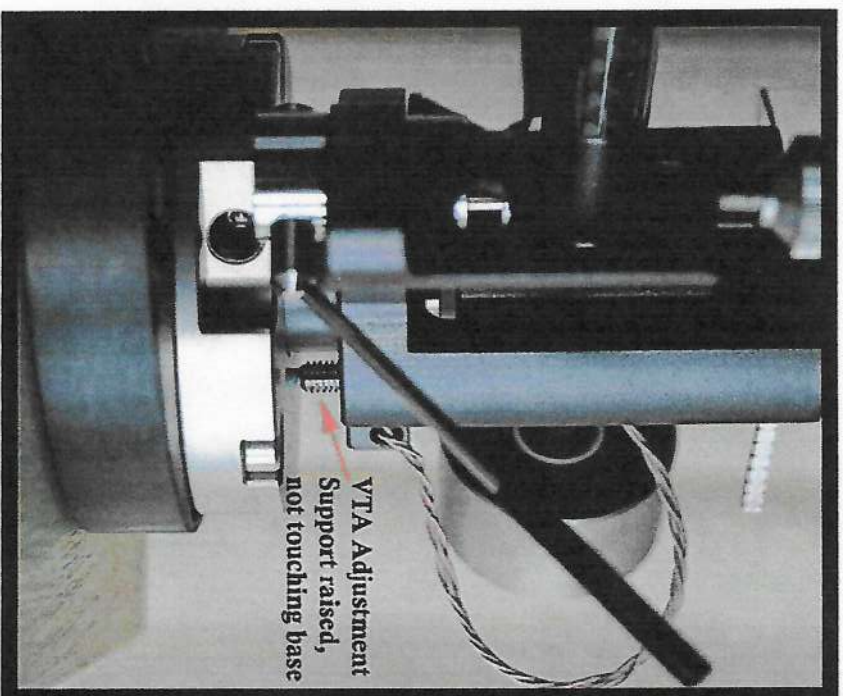

Please follow the points step by step. If you have any questions or problems, please contact us, we would be glad to help.
Go carefree to the assembling, but watch over the cartridge!
If all these points are performed, you can enjoy a new dimension of their LP's!!!

Experience one of the best tone arms in the world today !

VTA / Mount The Tonearm

First level the turntable. Take the tone arm and turn with the hex wrench S2 the VTA screw clockwise until the screw poke out approx. 18mm (check picture below). Turning the tool clockwise will bring the screw out, and counter clockwise will bring the screw in.

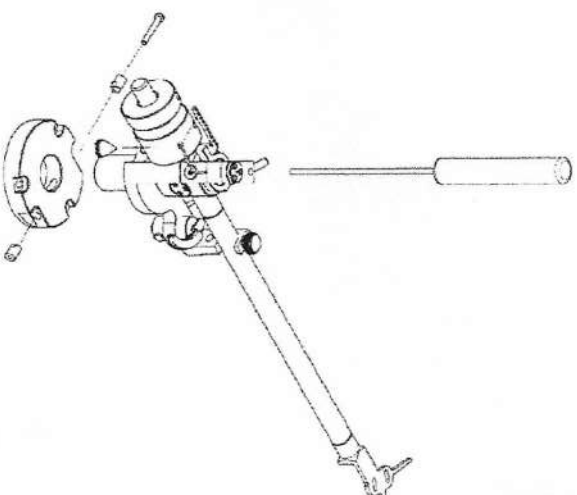
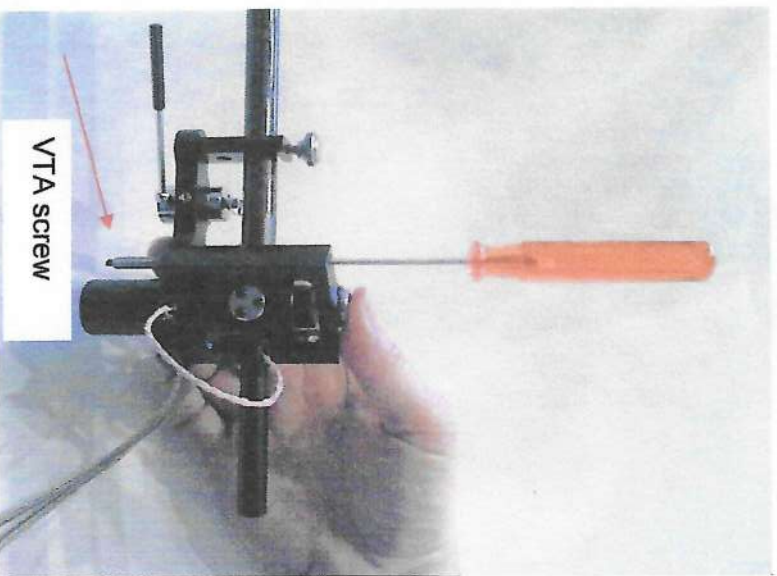

Put the tone arm careful in the Arm Collar hole until the VTA screw touch the Arm Collar. If tone arm shaft don't slight properly, untighten the Arm shaft clamp a little bit.

Installing Arm Shaft Clamp

Note that the Arm Shaft Clamp has 3 parts - a screw and 2 metal pieces. This will go into the hole of the Arm Collar as shown below on **Image**. Place the surface of the arm shaft clamp same like pictures.

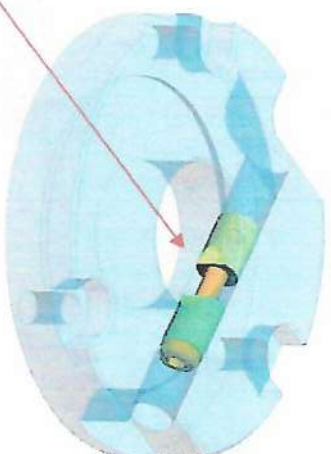
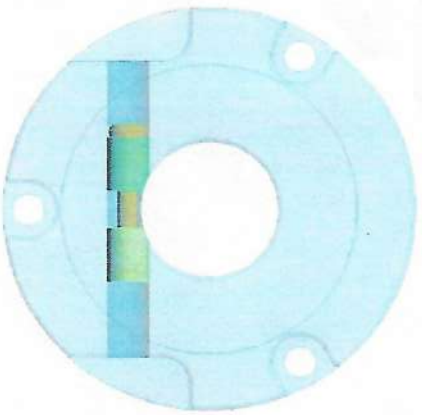

Surface tangential to the
arm shaft hole

Algemeinidentifiers:

Kanten geïsoleerd

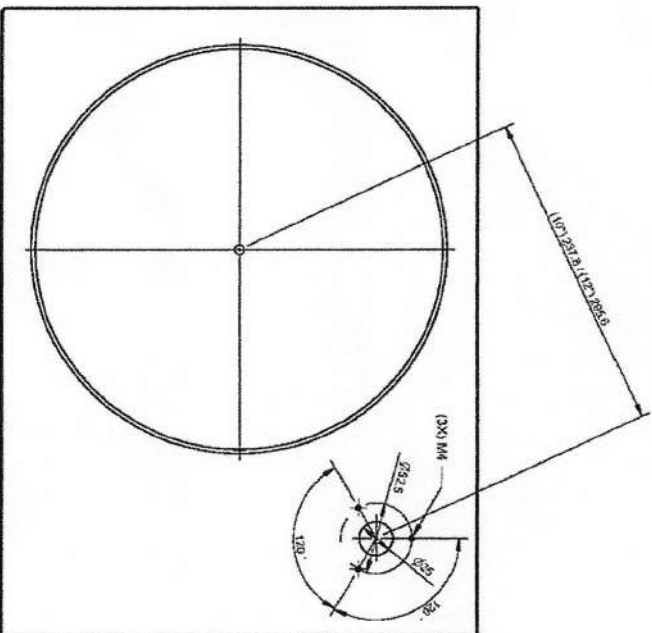
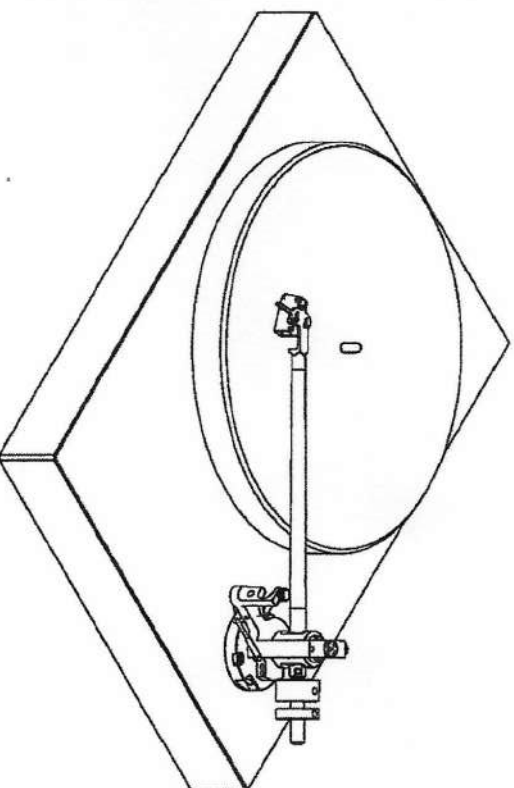
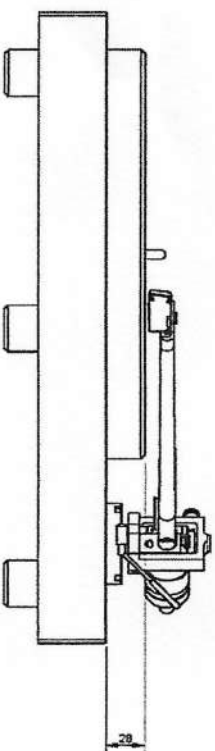

Itemref	Quantity	Tijdstamp, designation, material, dimension etc			Article No/Reference	
Drawn by		Material	Surface	Colour	Date	Scale
FSA					17.08.08	1:3
GRANDEZZA 10" - 12" ON TURNTABLE						
Checked by						

Depending on the tonearm length, this Pin is inserted in the appropriate hole, just enough until you can see the sharp point stick out at the other end. Temporarily lock it into place with the Liner Pin screw (F).

Remove any record from the turntable platter. If you have a mat, leave it on. Put the Protractor on top of the platter, with the hole indicated as going over the spindle hole. This Protractor is about the same height as a 180g record.

Mount the Collar board on your turntable. Check pictures below and geometrical data above:

- A - Arm Collar screws (3 x M4) - used for securing the Arm Collar onto a turntable armboard
- B - Arm Shaft Clamp - this will be inserted into the Arm Collar, and will clamp the tone arm shaft to the Arm Collar.

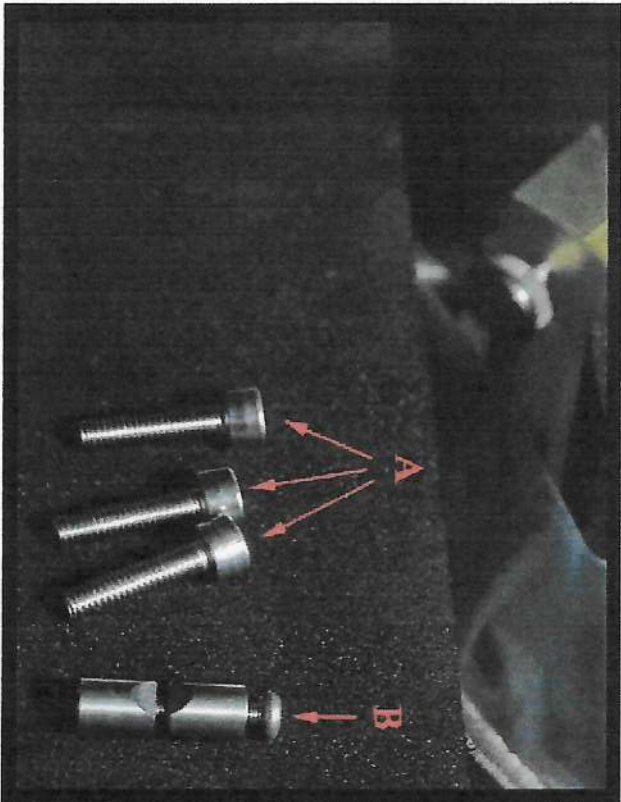

Mounting instructions

You need the ruler to adjust the distance between tone arm pivot and turntable center (data you find above).

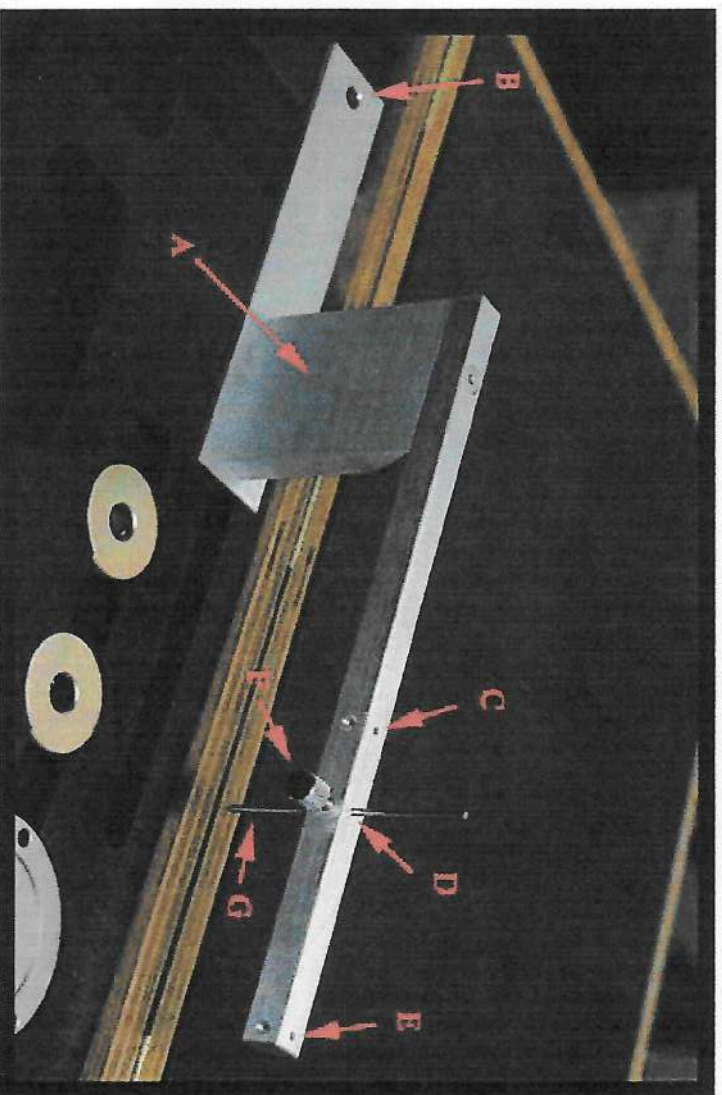

A - The Distance Gauge (Liner) - specially made only for our tone arms. This tool is used to get the correct distance between the turntable spindle and the pivot point of the tonearm

B - Liner Hole - this goes over the spindle C, D, and E are holes that mark the distance between the pivot point and the spindle

D - for TP125 10" tonearms

G - Liner Pin - it is not easy to guess or estimate whether the arm's pivot point aligns to these holes. The Liner Pin (G) below eliminates the guessing part.

What's inside

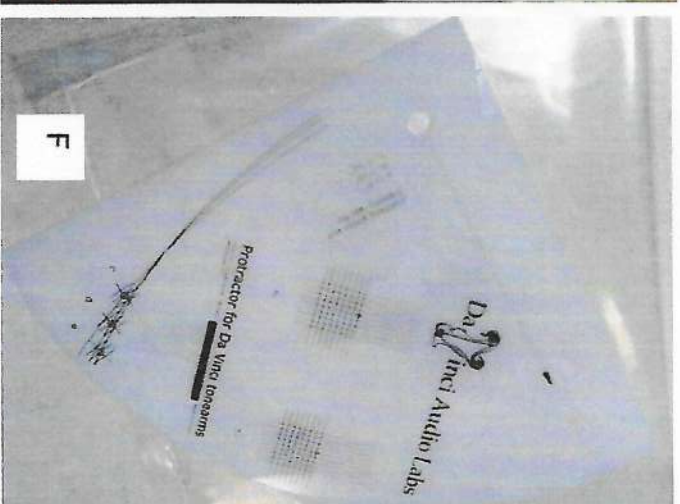
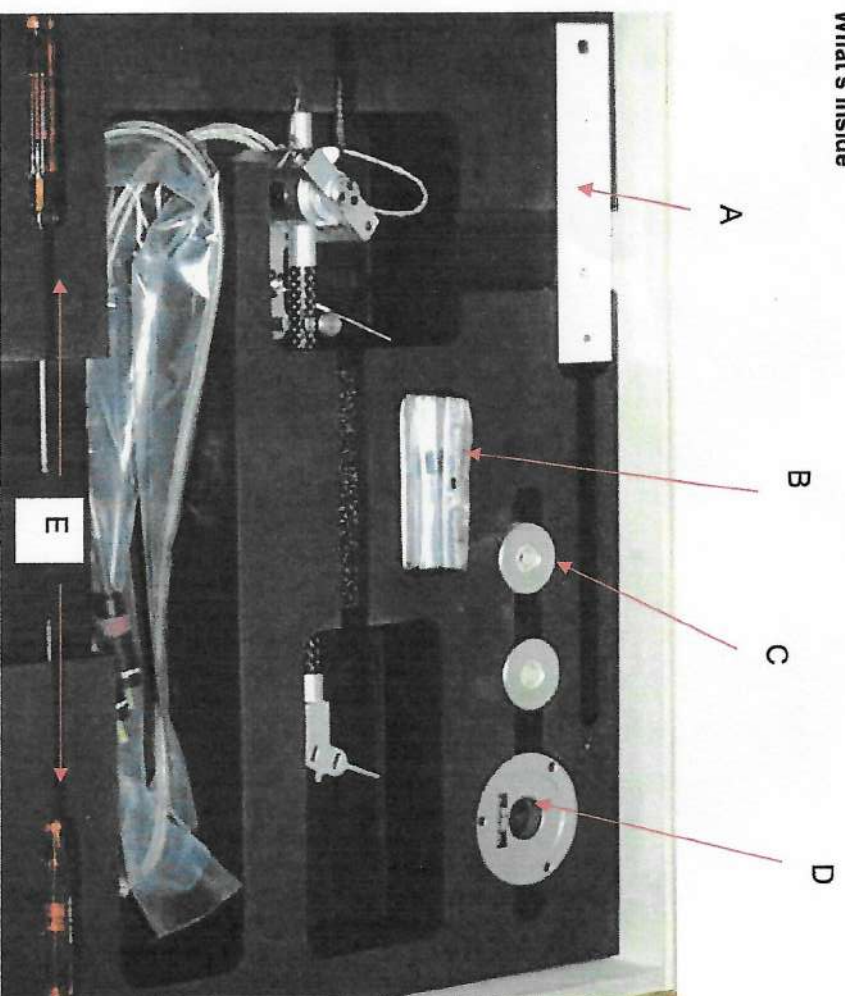

- A – Distance Gauge, also called Liner
- B – Arm Collar screws, arm shaft clamp, Liner Pin Guide, Liner Pin Guide screw lock
- C – counterweights
- D – Arm Collar
- E - Ball Point Hex wrench (S2 and S3)
- F - Protractor



DavinciAudio Noble tone arm setup Guide

Geometrical data & tonearm specification:	10°
Weight approx.	480g
Cartridge weight:	to – 22g
Distance - tonearm pivot to stylus tip:	254.00mm
Distance - tonearm pivot to turntable centre:	237.80mm
Cartridge offset angle:	21.60°
Inner null radius:	66.04mm
Outer null radius:	120.90mm
Overhang	16.2mm
Effective mass:	11g – 12 g



DaVinciAudio's Nobile tone arm



The Tone arm „Nobile“ set a milestone in musicality and emotionality.

Specifically selected materials such as carbon tube, steel, and aluminium comes together to achieve this unique representation.

The special hand polished bearing technology developed by a Swiss clock manufacturer bring for the musical highlights clear for even the most discerning music listener.

Highlights:

- carefully selected materials
- Swiss precision technology for top Swiss quality
- Bearing block made of aluminium and high quality steel
- Double gimbaled ruby bearing
- The jewel bearings are hand polished to achieve an exceptional precision
- Anti skating
- Counterweights made of high quality steel
- Arm tube made of carbon
- Headshell made of aluminium
- Direct cable 1m, other length on request
- Protractor included

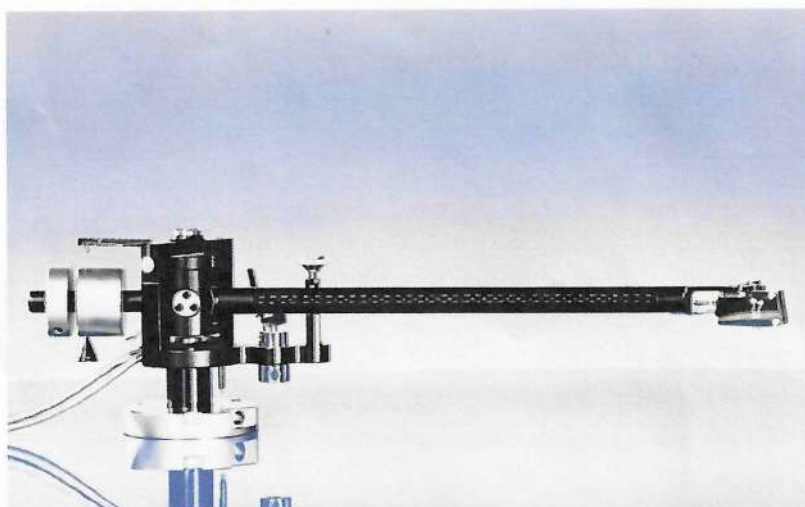

Built with the highest quality of DaVinciAudio Labs tradition
length available 10"

Easy to set up!

Experience one of best sounding tone arms available in the world today.

Further informations by your local dealer

by <http://www.da-vinci-audio.com> / info@da-vinci-audio.com
Freiburgstrasse 68, CH 3008 Bern, Switzerland

or for

Europe <http://www.virtu-corner.ch> / welcome@virtu-corner.ch ,
Vordermärchligenweg 36, CH 3112 Allmendingen b. Muri, Switzerland
Tel. +41 78 920 46 14